

## TECHRITE EITAR SWITCH

The Eitar thermoelectric safety valves have been specially designed for use with all kinds of gas appliances such as boilers, cookers, fryers, grills, heaters, ovens, water heaters.

- Internal elements resistant to the action of gases.
- Stainless steel spring.
- The body and cover are made of Aluminum alloy.
- They are equipped with thermoelectric safety.

### INSTALLATION INSTRUCTIONS

<b>Certificate</b>	: GMK 10295
<b>Model</b>	: 6400 Flame Failure device
<b>Rated Working Pressure</b>	: 18 kPa
<b>Temperature Limitation</b>	: 125 degrees C
<b>Flow Rate:</b>	: 8 M <sup>3</sup> /h Natural gas at 250 Pa pressure drop
<b>Connection</b>	: 20 mm BSP
<b>Thermocouple</b>	: M9 Hold on 2 – 4 seconds Drop out 35 – 50 seconds
<b>Gas Type</b>	: All Gases
<b>Mounting Position</b>	: All positions
<b>Serviceability</b>	: Non serviceable



MODEL No.	FUEL	INLET SIZE	RATING (MJ/hr)
EI 0001	NG/LPG	3/4" BSP	165

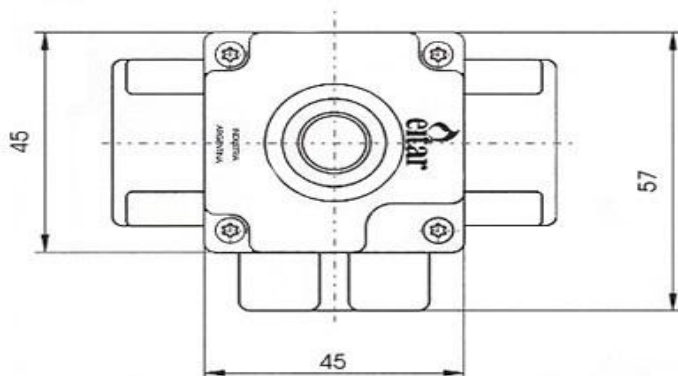
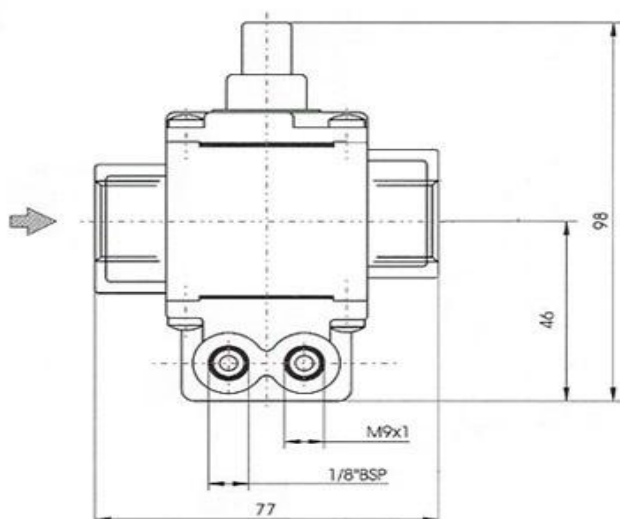

## TECHRITE CONTROLS AUSTRALIA PTY.LTD

Victoria - Head Office  
12 Yiannis Court  
Springvale, Victoria 3171  
Phone: +61 3 9549 4444  
Fax: +61 3 9546 6069

Sydney Office  
Unit 10/19 Boden Road  
Seven Hills NSW 2147  
Phone: +61 2 9624 4486  
Fax: +61 2 9624 6449

Queensland Office  
Unit 20, 28 Burnside Road  
Ormeau QLD 4208  
Phone: +61 7 3807 9094  
Fax: +61 7 3807 9095

Email: [techrite@techrite.com.au](mailto:techrite@techrite.com.au)

[www.techrite.com.au](http://www.techrite.com.au)